

Kardany RDT / RDS

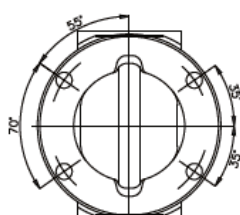

Model 1720 Flange



4-Hole Flange

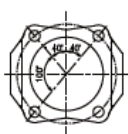

4-Hole
RECT Flange

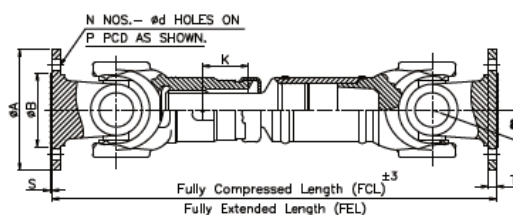

8-Hole Flange

TECHNICAL DATA

Drive Shaft Series	Short Duration Torque Nm	Flange Dia ØA	Spigot Dia. ØB +0.050 0 57.1	Spigot Height S	Flange THK T±0.5	No. of Flange Holes N	Bolt Hole Dia. ØD (+0.2, 0)	Flange PCD P	Angle A° Max.	* Model - RDT		* Model - RDS	
										Slip Movement K	Length FCL-FEL	Slip Movement K	Length FCL-FEL
1130	550	87.3	57.1	2.60	5.20	4	8.20	69.95/69.80	17	42.8	315-358	23.5	208-232
1310 ■	1085	Rect Flange	60.27	1.52	7.10	4	10.50	79.45/79.30	25	50.8	335-385	25	250-275
												49.2	281-330
												30	250-280
1410 ■	2034	Rect Flange	69.8	1.50	7.25	4	12.50	95.35/95.20	20	58	471-529	40	264-304
												52	290-342
												50	270-320
1480 ■	2712	Rect Flange	95.2	1.80	10.30	4	12.85	120.75/120.60	20	63.5	418-481	50	270-320
1550 ■	3255	Rect Flange		1.60	10.30	4	12.75	120.75/120.60	20	63.5	445-508	25	248-273
1610	4950	174.5	168.2	1.59	8.00	8	10.50	155.60/155.45	20	70	500-570	33	308-341
												40	340-380
1710	6511	203.0	196.77	2.00	7.60	8	10.50	184.10/184.22	20	133	638-771	45	377-422
												98	485-583
1720	6511	150	146	±0.1	3	4	13.00	130.00/130.2	15	133	650-783	98	480-578
												104	618-722